

Kabin Ölçüleri
Schrankabmessungen

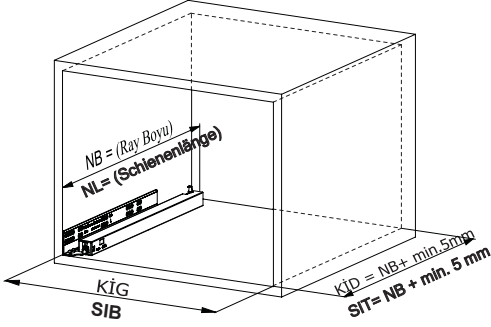

Kabin İç Genişliği	: KİG	Schrank-Innenbreite	: SIB
Kabin İç Derinliği	: KİD	Schrank-Innentiefe	: SIT
Çekmece Derinliği	: ÇD	Schublادتiefe	: SLT
Çekmece İç Genişliği	: ÇİG	Schubladen-Innenbreite	: SLİB
Nominal Boy (Ray boyu)	: NB	Nennlänge	: NL

Tavsiye Edilen Vida ve Şablonlar

Empfohlene Schrauben und Schablonen

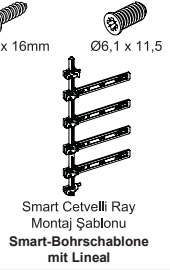
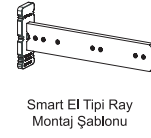
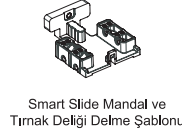
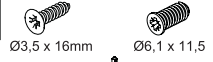

Rayların Vida Konum Ölçüleri
Schraubenposition der Schienenführungen

Rayı, koyu renk ile işaretlenmiş deliklerden vidalayınız.
Schrauben Sie die Schiene an den markierten Löchern fest.

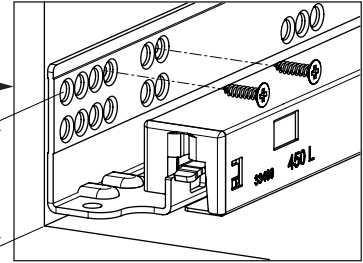
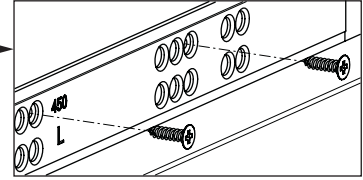
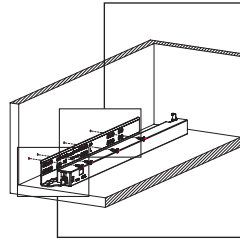
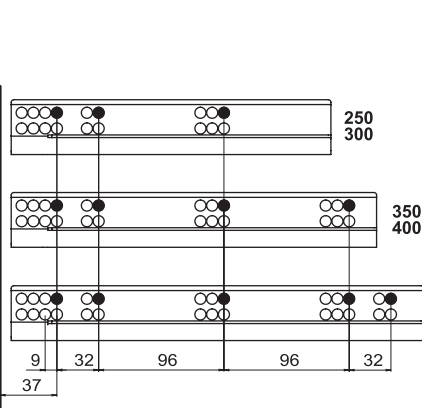

Çekmece Ölçüleri
Schubladenabmessungen

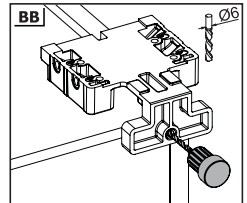
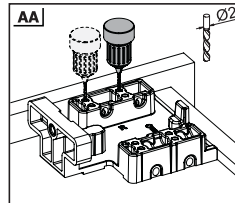
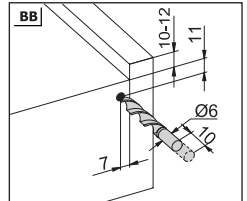
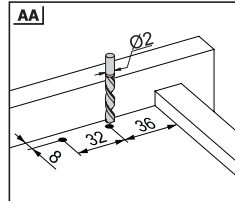
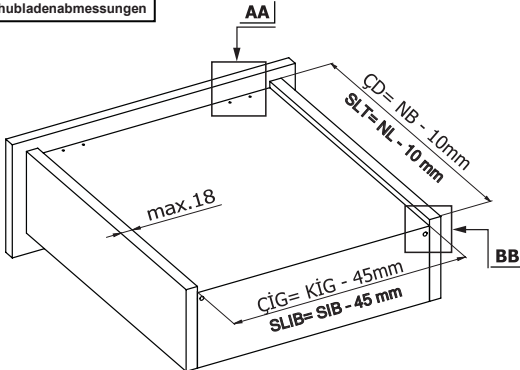

1

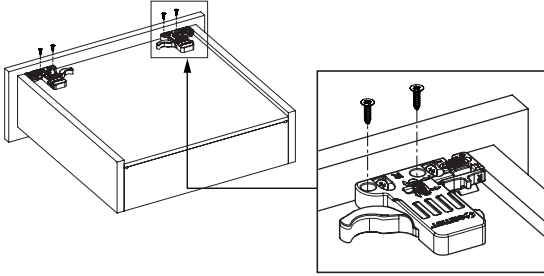

Not: Çekmece taban kalınlığı 12 mm'den küçük olduğunda, açılı mandal bağlama deliklerini kullanınız.

Hinweis: Verwenden Sie zur Montage von Smart Lock abgewinkelte Löcher, wenn die gewählte Holzbodenbreite weniger als 12 mm beträgt.

AA

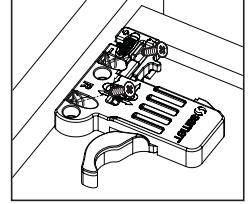
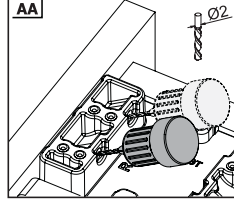

2

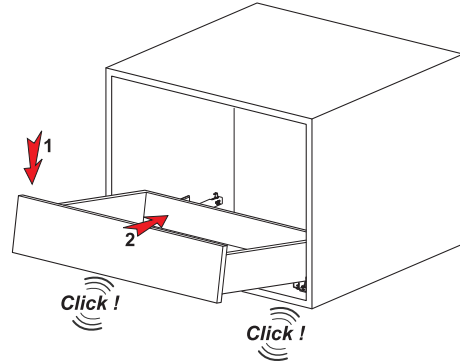

3

Somunu çevirerek, yukarıya doğru ayar yapabilirsiniz.
Die Aufwärtspositionierung lässt sich durch Drehen des Knopfes anpassen.

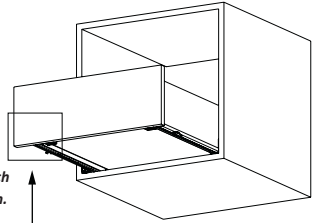
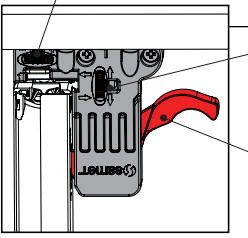

Somunu çevirerek, sağ-sol ayarını yapabilirsiniz.

Die Links-Rechts-Positionierung lässt sich durch Drehen des Knopfes anpassen.

Mandal kollarına aynı anda basarak, çekmeceyi kolayca yerinden çıkarabilirsiniz.
Sie können die Schublade leicht herausnehmen, indem Sie einfach den Drücker der Smart Lock-Arretierung betätigen.

Smart EI Tipi Ray
Montaj Şablonu
Smart-Bohrschablone

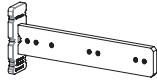

Kod / Code

12799902

12799904

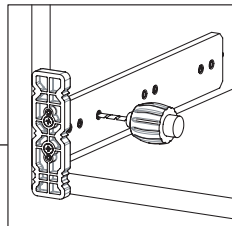
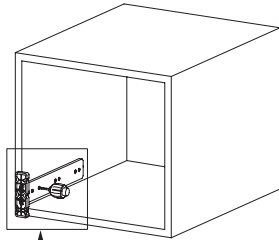

Smart Cetveli Ray
Montaj Şablonu
Smart-Bohrschablone mit Lineal

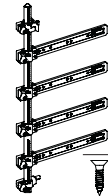

Kod / Code

12799901

12799905

