

Kabin Ölçüleri
Schrankabmessungen

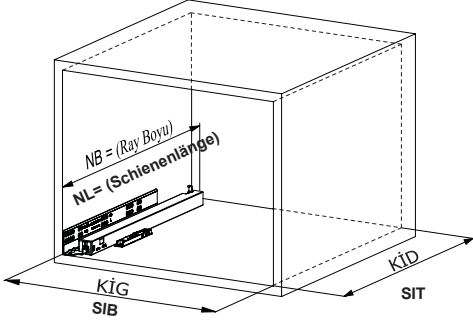

Kabin İç Genişliği	: KIG	Schrank-Innenbreite:	SIB
Kabin İç Derinliği	: KID	Schrank-Innentiefe:	SIT
Çekmece Derinliği	: ÇD	Schubladentiefe:	SLT
Çekmece İç Genişliği	: ÇİG	Schubladen-Innenbreite:	SLIB
Nominal Boy (Ray boyu):	NB	Nennlänge:	NL

Tavsiye Edilen Vida ve Şablonlar
Empfohlene Schrauben und Schablonen

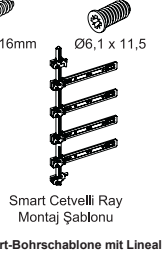
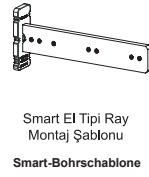
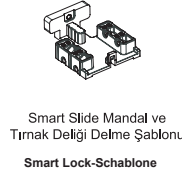

Rayların Vida Konum Ölçüleri
Schraubenposition der Schienenführungen

Rayı, koyu renk ile işaretlenmiş deliklerden vidalayınız.
Schrauben Sie die Schiene an den markierten Löchern fest.

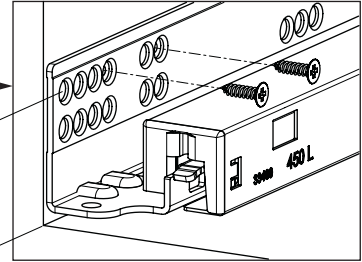
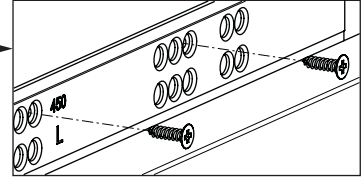
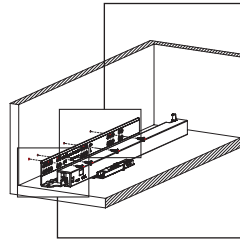
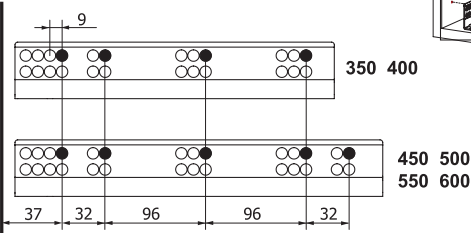

Çekmece Ölçüleri
Schubladenabmessungen

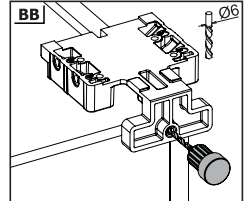
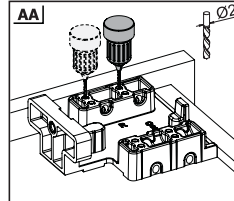
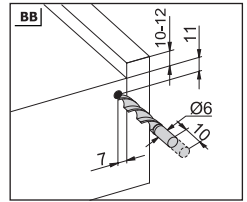
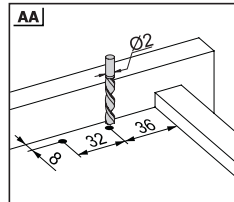
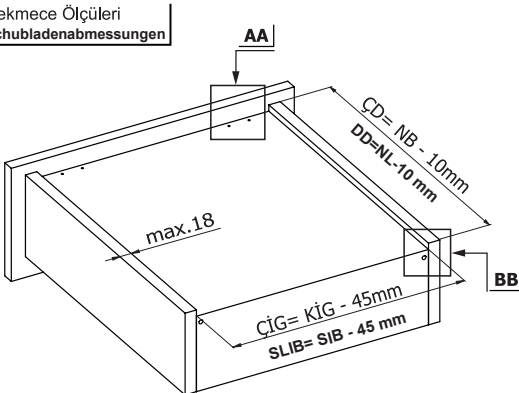

1

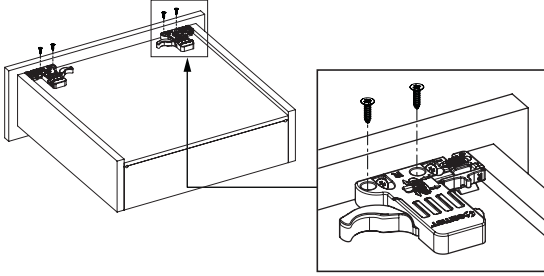

Not: Çekmece taban kalınlığı 12 mm'den küçük olduğunda, açılı mandal bağlama deliklerini kullanınız.

Hinweis: Verwenden Sie abgewinkelte Löcher, um SmartLock zu montieren, wenn die ausgewählte Holzbodenbreite weniger als 12 mm beträgt.

AA

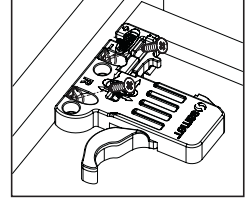
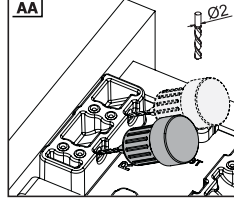

2

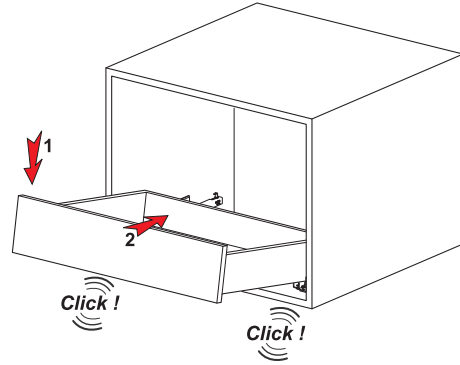

3

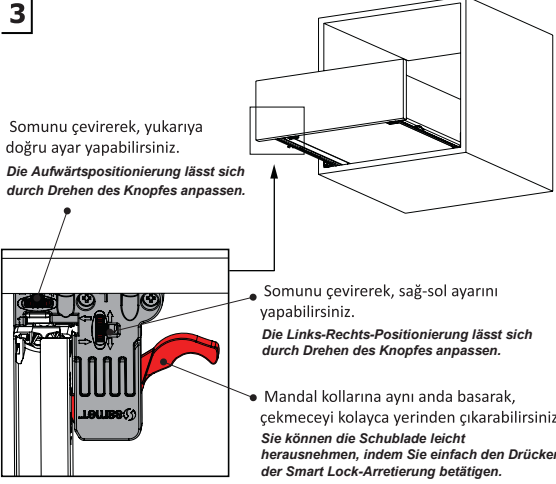

Smart El Tipi Ray
Montaj Şablonu
Smart-Bohrschablone

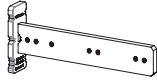

Kod / Code

12799902

12799904

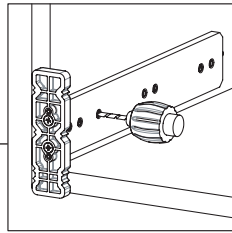
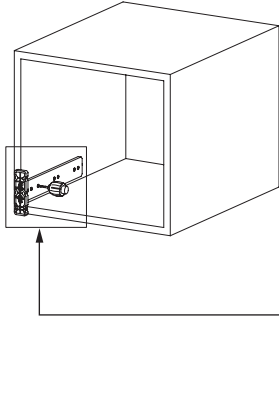

Smart Cetveli Ray
Montaj Şablonu
Smart-Bohrschablone mit Lineal

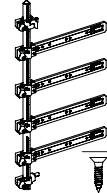

Kod / Code

12799901

12799905

