

- DO -

- DON'T -

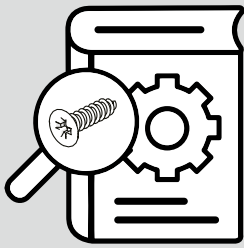

1 Refer to the GS-Class User Manual for specific screw types to be used with the GS-Class slides.



>Ø3,5x16 mm

Screws longer than 16 mm should not be used.

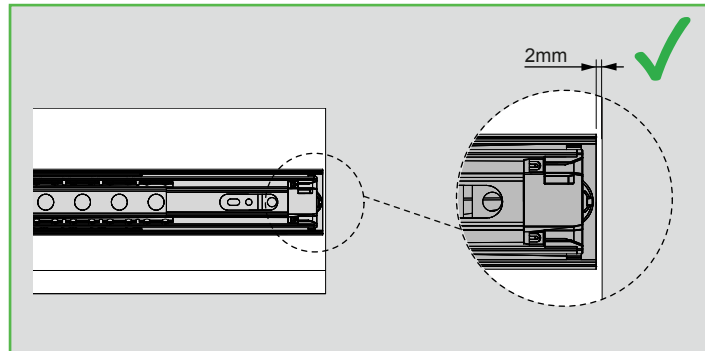

2 For 46 mm ball bearing slides, the set back should be a maximum of 2 mm for overlay applications.

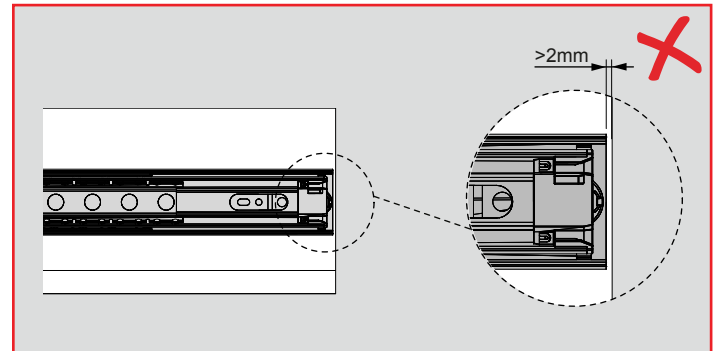

For 46 mm ball bearing slides, the set back should not be more than 2 mm for overlay applications.

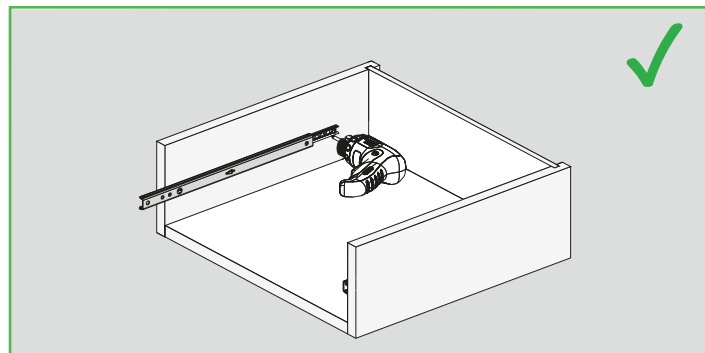

3 Ball bearing slides without latch should be installed to the cabinet first.

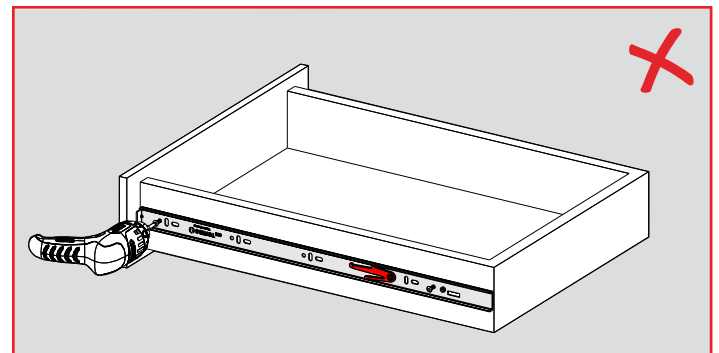

Ball bearing slides without latch should not be installed to the drawer box first

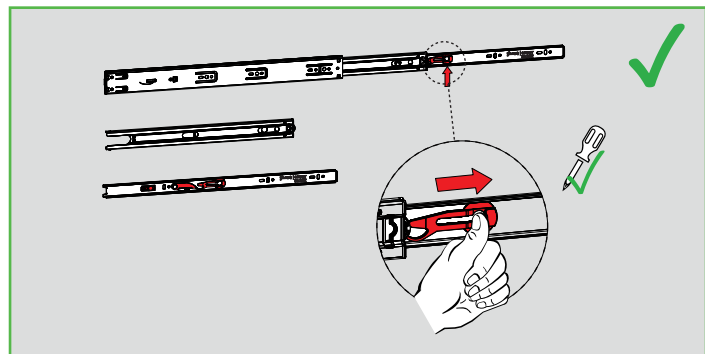

4 You may use a screwdriver if you cannot engage the removal latch by hand on the ball bearing slides with latch.

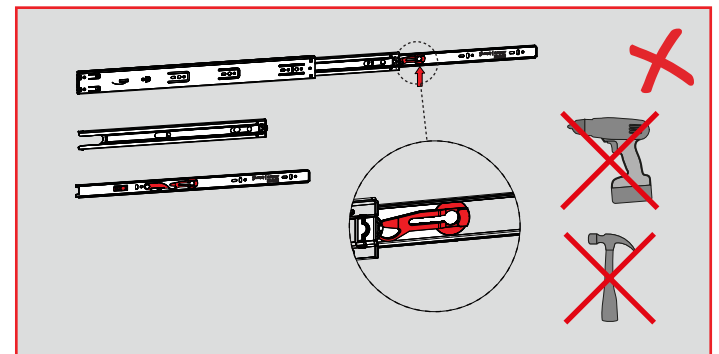

You should not use any other tool to remove ball bearing slides with latch

- DO - 

5

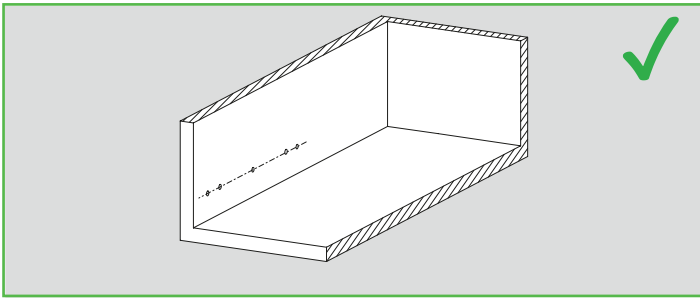

Assembly holes should be level on the cabinet.

- DON'T - 

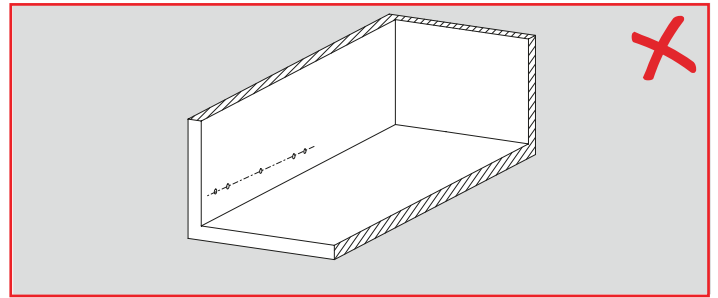

Assembly holes should not be out of level on the cabinet

6

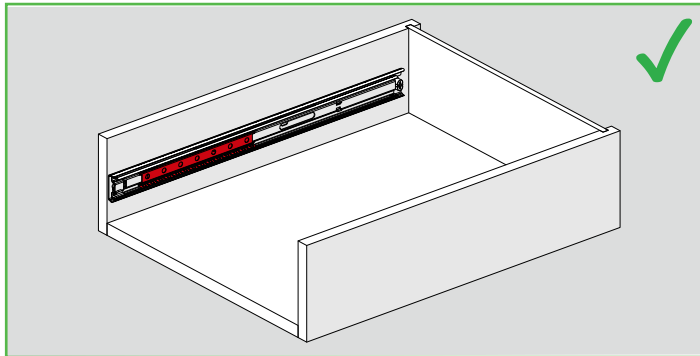

The ball bearing carrier should be aligned to the front position before installing the drawer box.

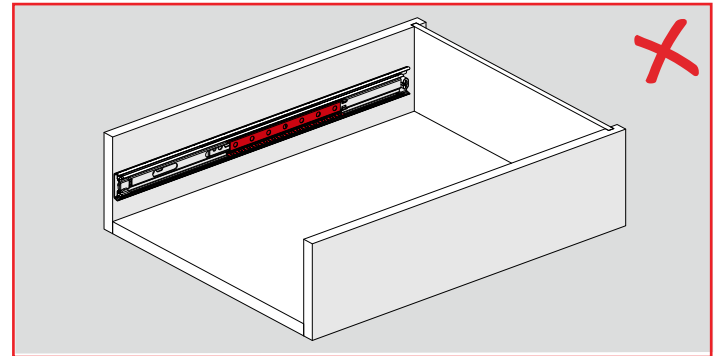

The ball bearing carrier should not be pushed back before installing the drawer box.

7

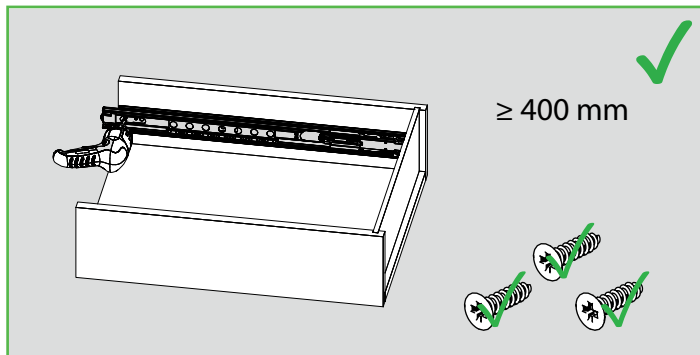

Minimum of 3 screws should be used for slide lengths over 400 mm.

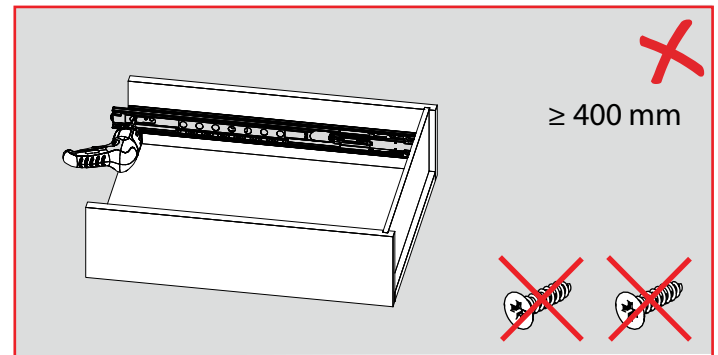

Less than 3 screws should not be used for slide lengths over 400 mm.