

- DO - 

- DON'T - 

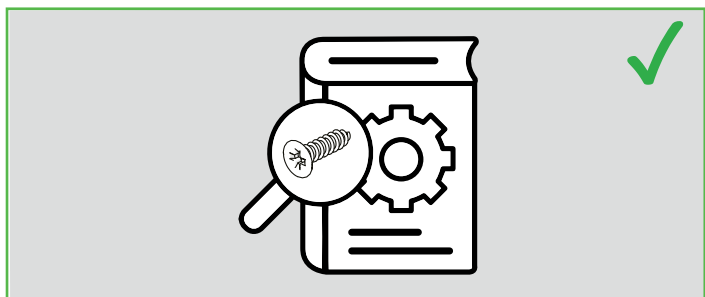

1 Refer to the SO-Class User Manual for specific screw types to be used with the SO-Class slides.



Screws longer than 16 mm should not be used.

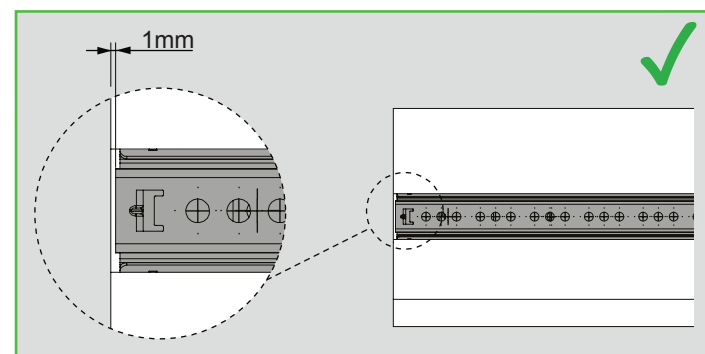

2 For 17 mm and 27 mm ball bearing slides, the set back should be a maximum of 1 mm for overlay applications.

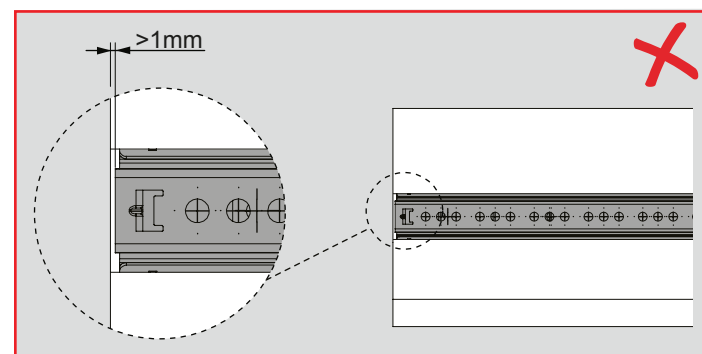

For 17 mm and 27 mm ball bearing slides, the set back should not be more than 1 mm for overlay applications.

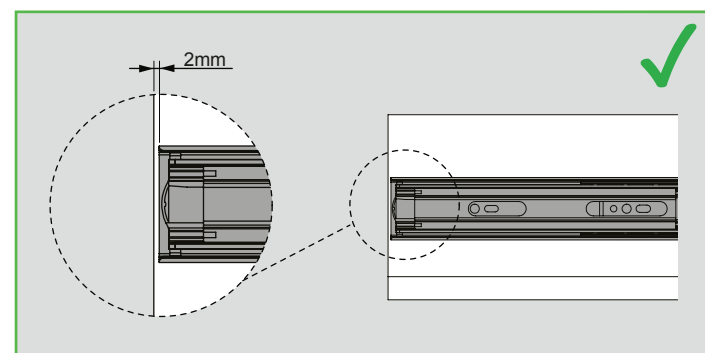

3 For 35 mm, 43 mm and 46 mm ball bearing slides, the set back should be a maximum of 2 mm for overlay applications.

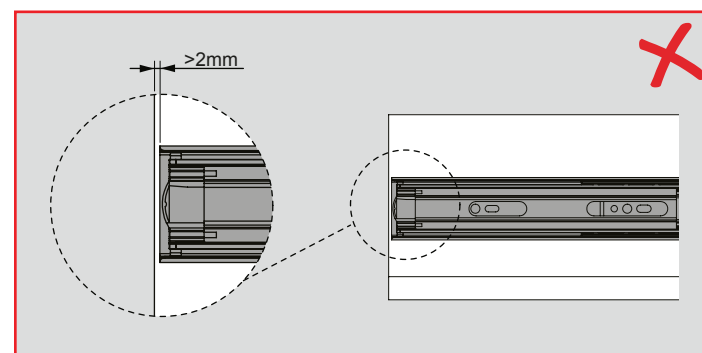

For 35 mm, 43 mm and 46 mm ball bearing slides, the set back should not be more than 2 mm for overlay applications.

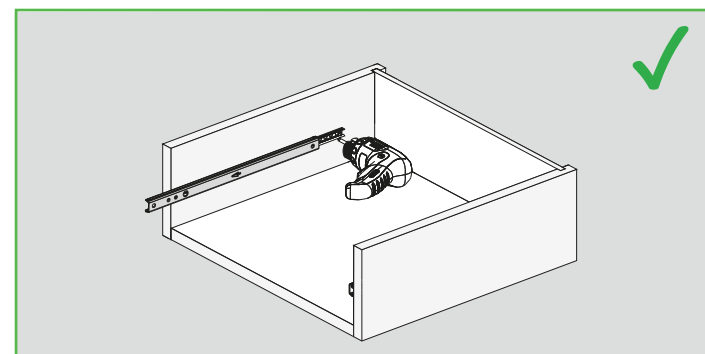

4 Ball bearing slides without latch should be installed to the cabinet first.

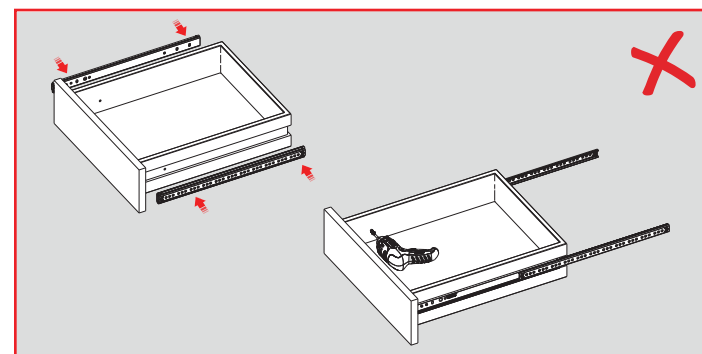

Ball bearing slides without latch should not be installed to the drawer box first

- DO - 

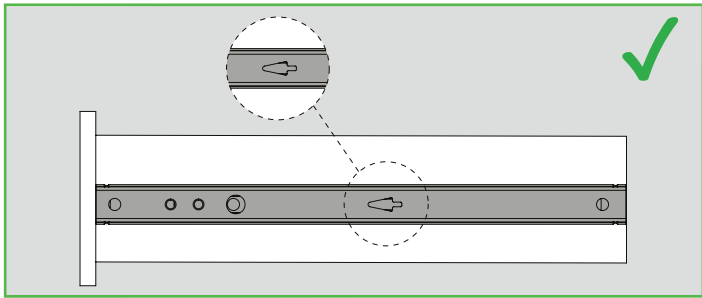

5 The arrow should be aiming towards the front of the drawer box for 17 mm ball bearing slides.

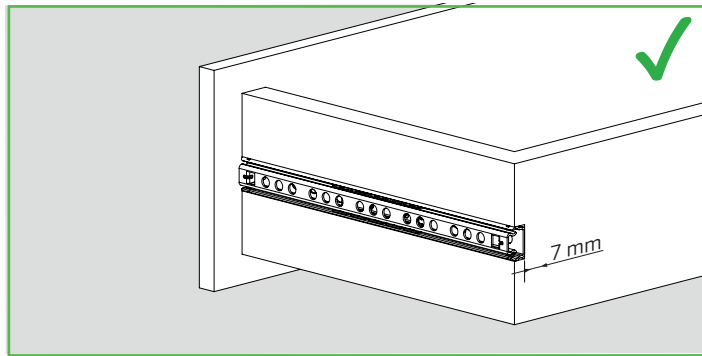

6 Depth of the ball bearing channel on the drawer box should be a maximum of 7 mm.

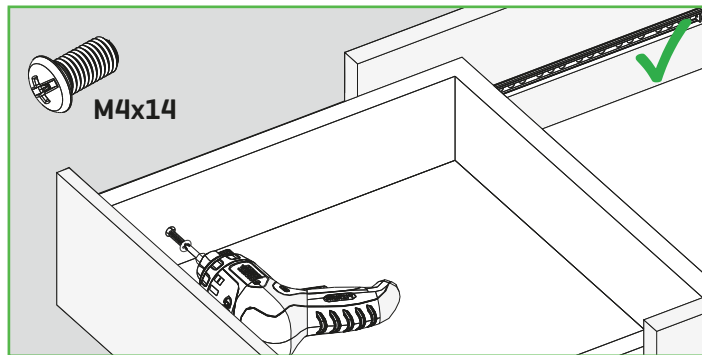

7 M4 thread screw length should be max. 14 mm for 17 mm and 27 mm ball bearing slides with latch.

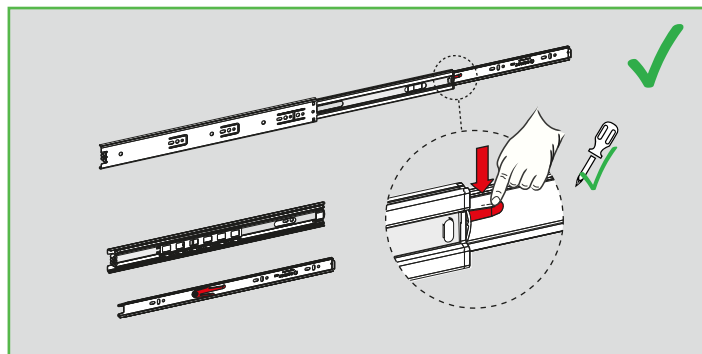

8 You may use a screwdriver if you cannot engage the removal latch by hand on the ball bearing slides with latch.

- DON'T - 

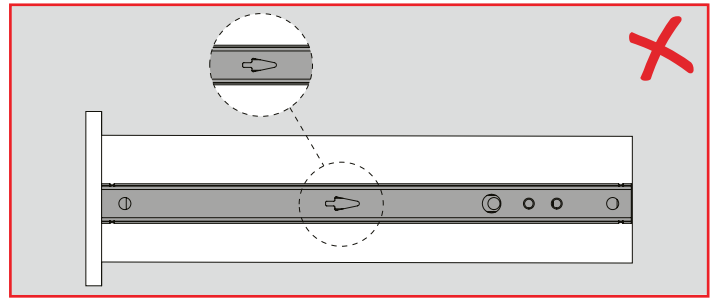

The arrow should not be aiming towards the back of the drawer box for 17 mm ball bearing slides.

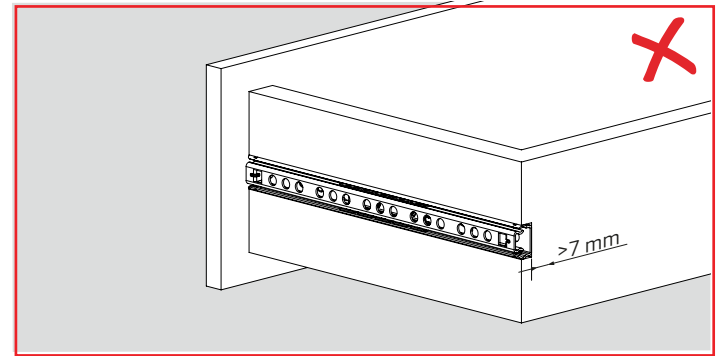

Depth of the ball bearing channel on the drawer should not be deeper than 7 mm.

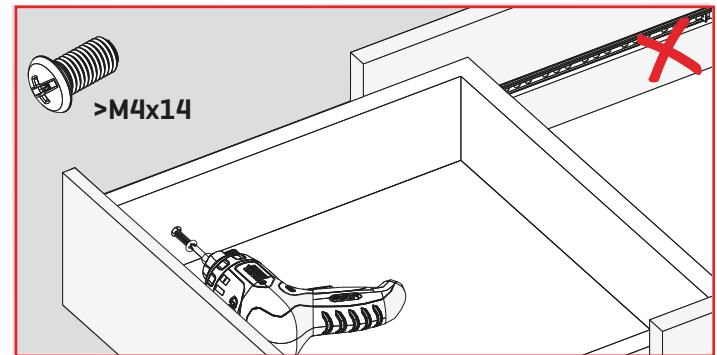

M4 thread screw thread length should not be longer than 14 mm for 17 mm and 27 mm ball bearing slides with latch.

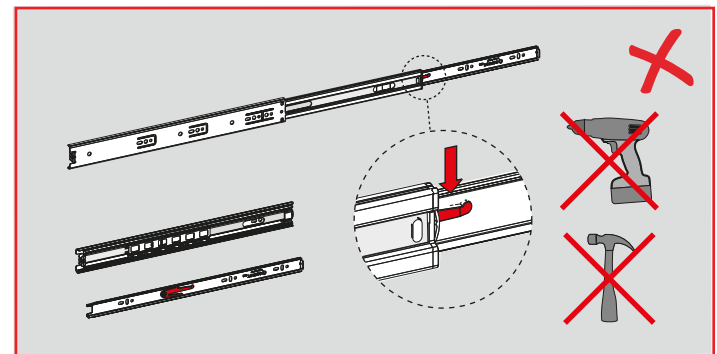

You should not use any other tool to remove ball bearing slides with latch

- DO - 

- DON'T - 

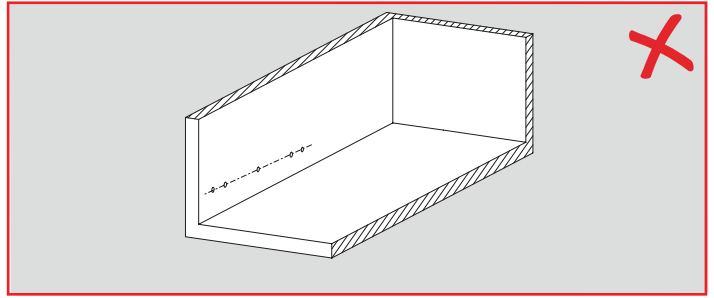
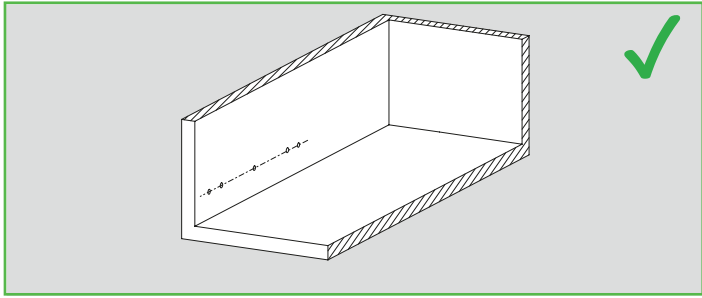

9 Assembly holes should be level on the cabinet.

Assembly holes should not be out of level on the cabinet

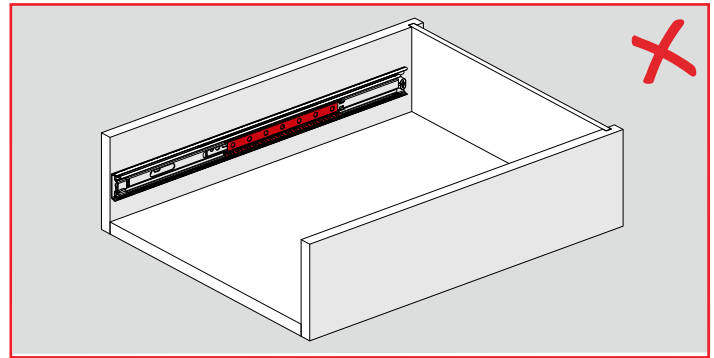
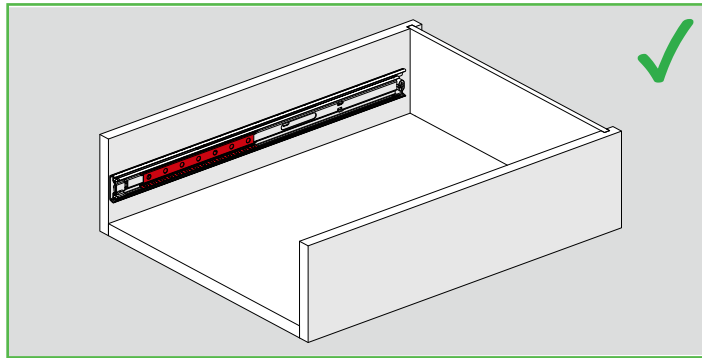

10 The ball bearing carrier should be aligned to the front position before installing the drawer box.

The ball bearing carrier should not be pushed back before installing the drawer box.

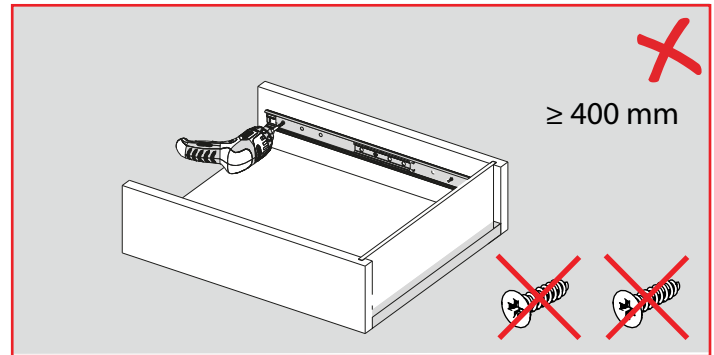
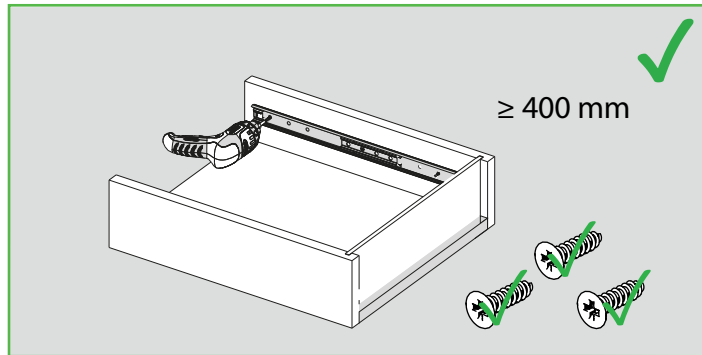

11 Minimum of 3 screws should be used for slide lengths over 400 mm.

Less than 3 screws should not be used for slide lengths over 400 mm.