

Dimensioni cassetto e armadio

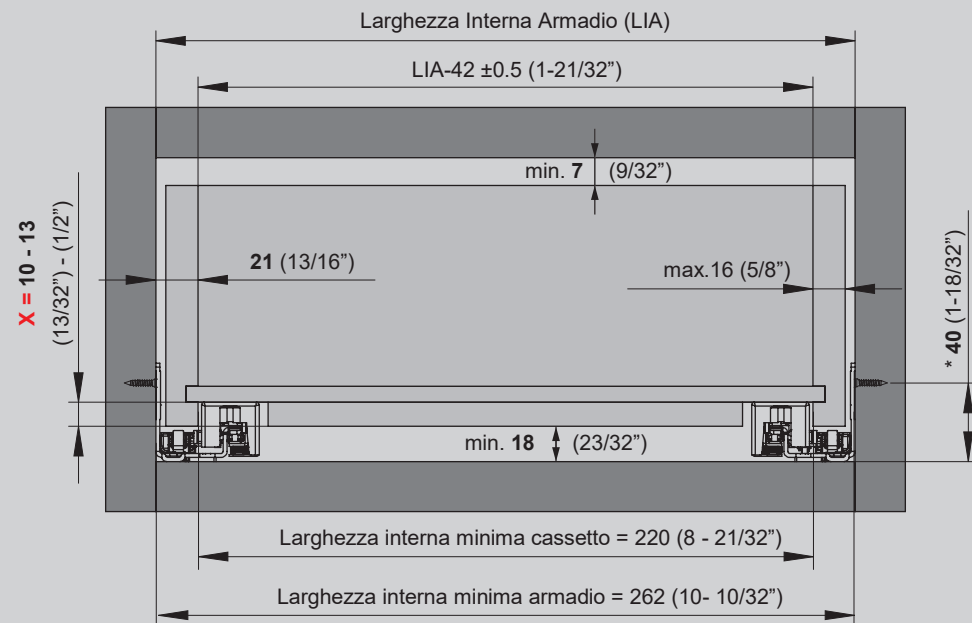

\*Nel montaggio inferiore di quelli senza telaio, l'altezza minima del centro della vite deve essere (\*) di min. 42mm (1- 21/32")

Preparazione lato posteriore cassetto

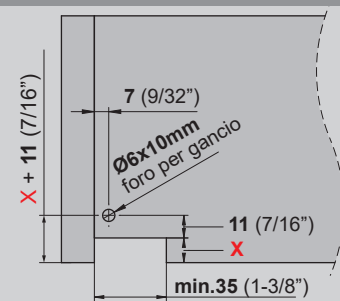

X = 10 - 13mm  
X = (13/32") - (1/2")

Staffa di montaggio posteriore

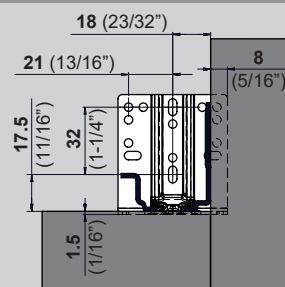

Nota: Utilizzare un minimo di tre viti per staffa.

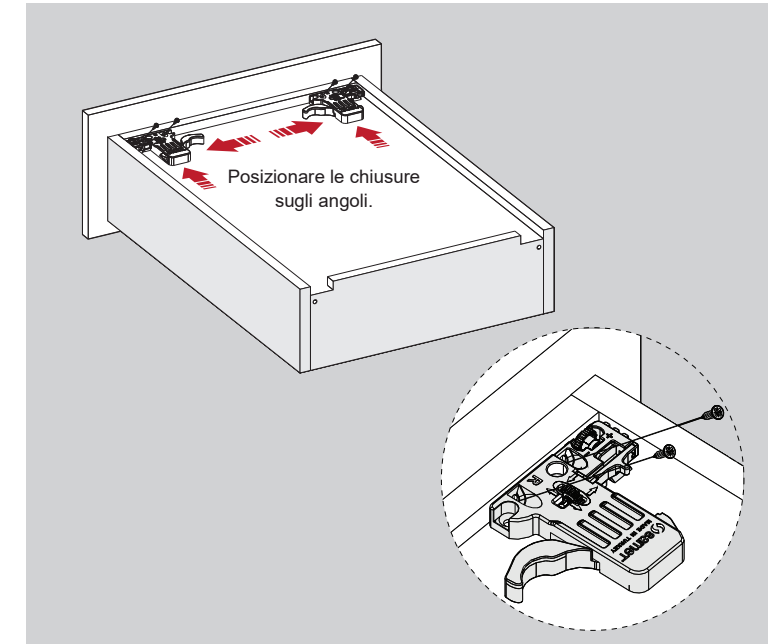
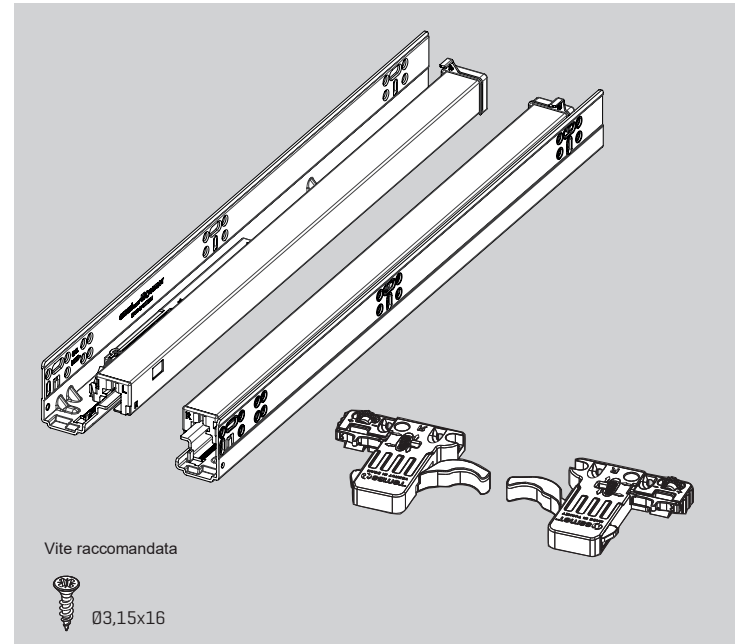

Specifiche di montaggio della guida

Compatibile con le staffe di montaggio posteriori in metallo.

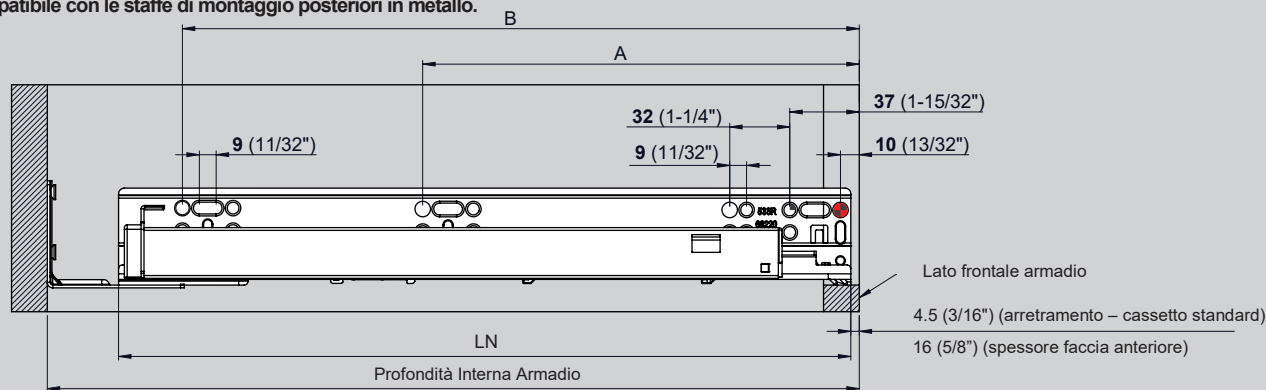

Lunghezza cassetto	Profondità interna cassetto con attacco posteriore		Lunghezza guida (LN)	Posizione delle viti per armadi senza telaio	
	Max	Min		A	B
229 (9")	310 (12-7/32")	270 (10-5/8")	261 (10-9/32")	133 (5-7/32")	229 (9")
305 (12")	368 (14-1/2")	328 (12-29/32")	319 (12-9/16")	165 (6-1/2")	261 (10-9/32")
381 (15")	444 (17-1/2")	404 (15-29/32")	395 (15-9/16")	165 (6-1/2")	357 (14-1/16")
457 (18")	520 (20-1/2")	480 (18-29/32")	471 (18-17/32")	261 (10-9/32")	453 (17-27/32")
533 (21")	597 (23-1/2")	557 (21-15/16")	548 (21-9/16")	261 (10-9/32")	517 (20-3/8")

Arretramento guida per cassetto standard (vedi tabella Cassetto standard)



Arretramento guida per cassetto rientrante (vedi tabella Cassetto rientrante)

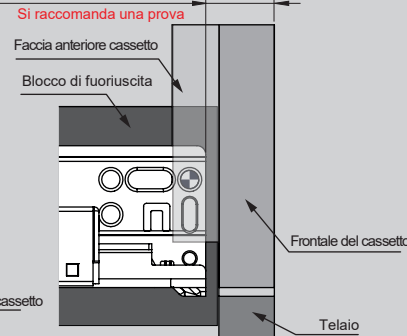

Cassetto standard		Arretramento	
Spessore faccia anteriore	13 (1/2")	1.5 (1/16")	4.5 (3/16")
	16 (5/8")	4.5 (3/16")	7.5 (5/16")
	19 (3/4")	7.5 (5/16")	

Cassetto rientrante		Arretramento			
Spessore faccia anteriore	13 (1/2")	17.5 (11/16")	20.5 (13/16")	23.5 (15/16")	26.5 (1-1/32")
	16 (5/8")	20.5 (13/16")	23.5 (15/16")	26.5 (1-1/32")	29.5 (1-5/32")
	19 (3/4")	23.5 (15/16")	26.5 (1-1/32")	29.5 (1-5/32")	
		16 (5/8")	19 (3/4")	22 (7/8")	
Spessore frontale cassetto					

Schema di conversione da millimetri a pollici

1	1.5	2	3	4	5	5.5	6	7	8	9	9.5	10	11	12	13	13.5	14	15	16	17	17.5	18	19	20	20.5	21	22	23	24	24.5	25.4
1/32	1/16	3/32	1/8	5/32	3/16	7/32	1/4	9/32	5/16	11/32	3/8	13/32	7/16	15/32	1/2	17/32	9/16	19/32	5/8	21/32	11/16	23/32	3/4	25/32	13/16	27/32	7/8	29/32	15/16	31/32	1

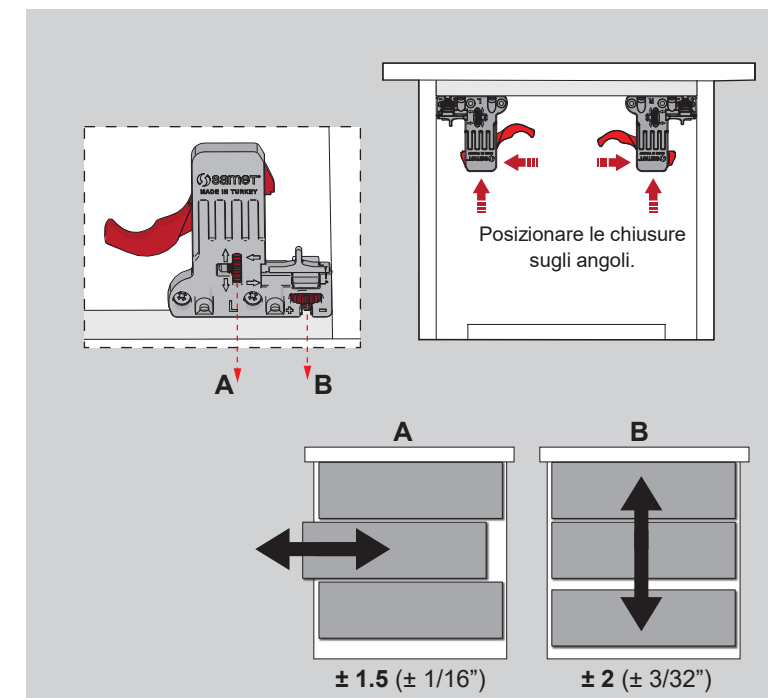
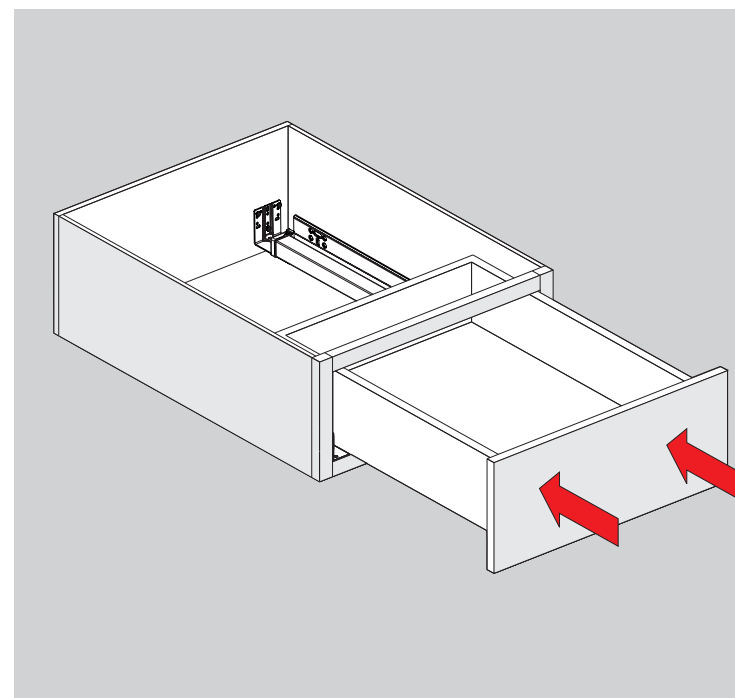
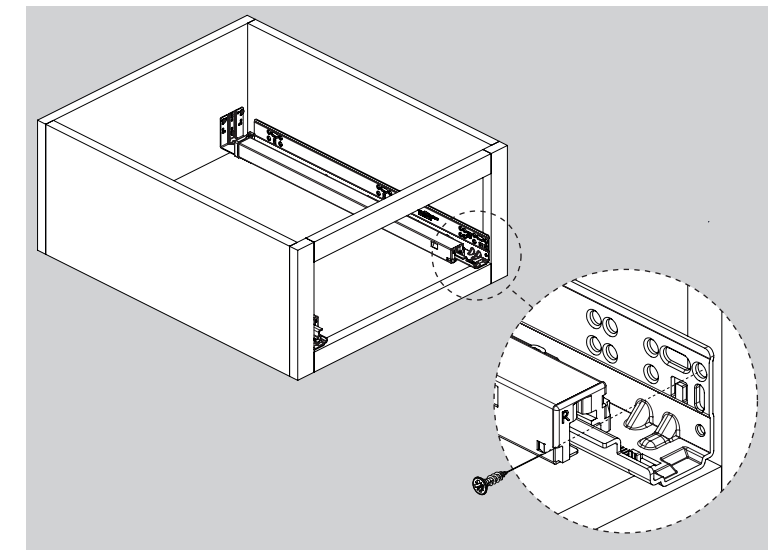
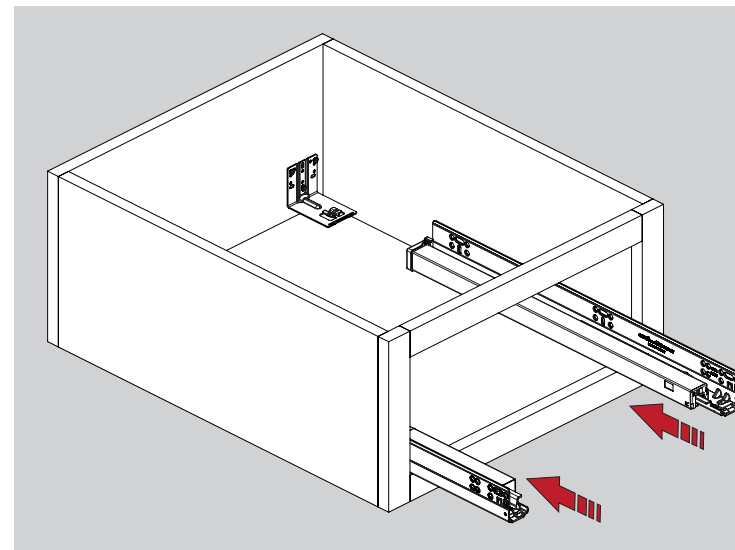

Dimensioni cassetto e armadio

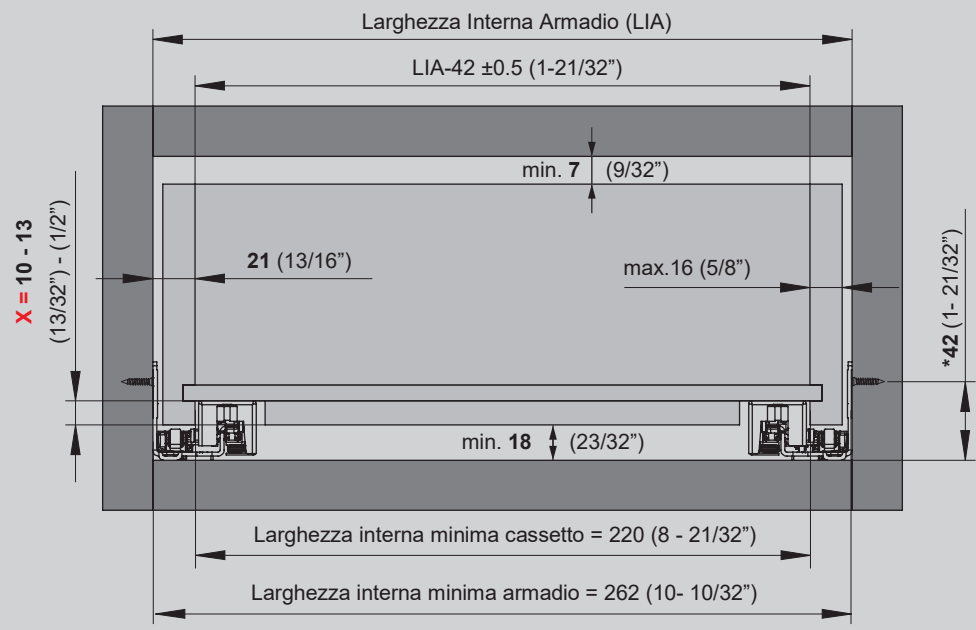

\*Nel montaggio inferiore di quelli senza telaio, l'altezza minima del centro della vite deve essere (\*) di min. 42mm (1- 21/32")

Preparazione lato posteriore cassetto

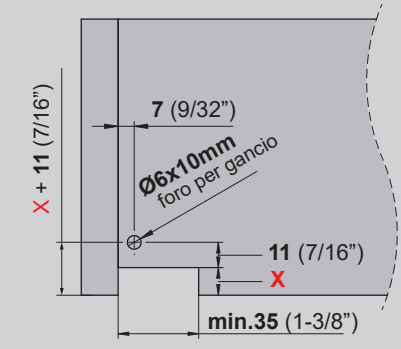

X = 10 - 13mm  
X = (13/32") - (1/2")

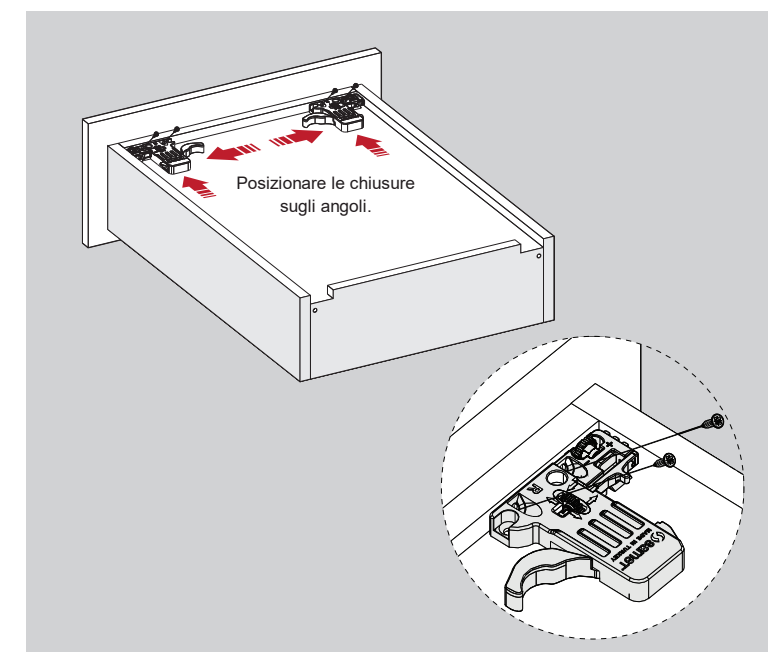
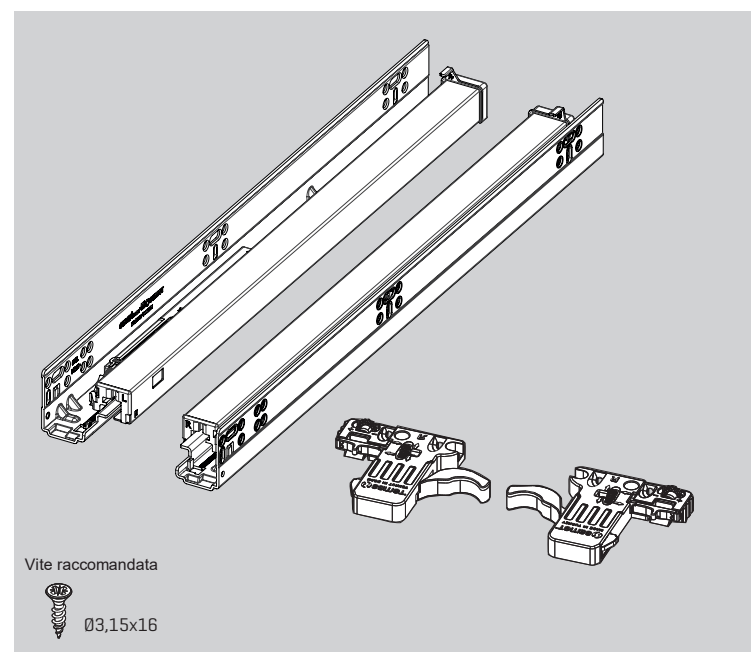

Specifiche di montaggio della guida

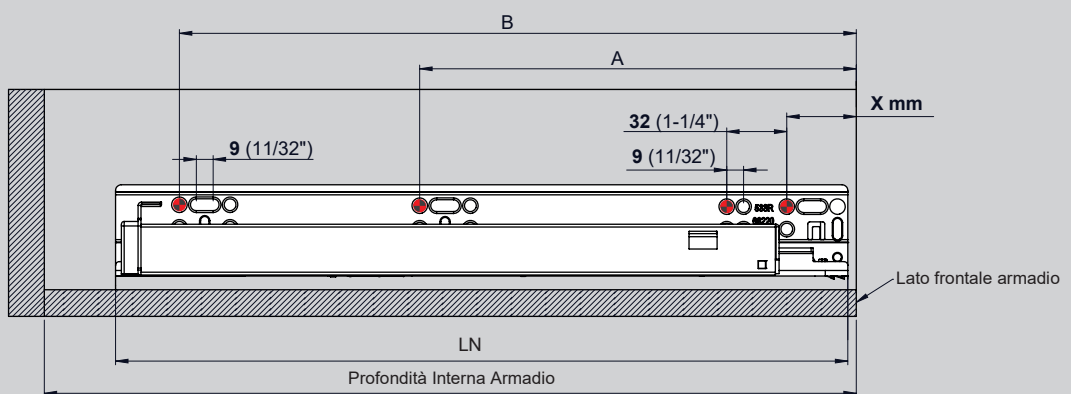

Lunghezza cassetto	Profondità interna minima armadio	Lunghezza guida (LN)	Posizione delle viti per armadi senza telaio	
			A	B
229 (9")	270 (10-5/8")	261 (10-9/32")	133 (5-7/32")	229 (9")
305 (12")	328 (12-29/32")	319 (12-9/16")	165 (6-1/2")	261 (10-9/32")
381 (15")	404 (15-29/32")	395 (15-9/16")	165 (6-1/2")	357 (14-1/16")
457 (18")	480 (18-29/32")	471 (18-17/32")	261 (10-9/32")	453 (17-27/32")
533 (21")	557 (21-15/16")	548 (21-9/16")	261 (10-9/32")	517 (20-3/8")

Arretramento guida per cassetto standard (vedi tabella Cassetto standard)  
Si raccomanda una prova

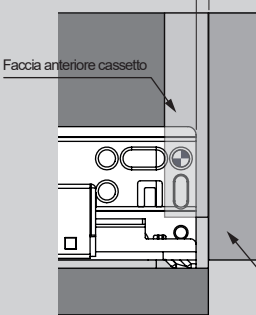

Arretramento guida per cassetto rientrante (vedi tabella Cassetto rientrante)  
Si raccomanda una prova

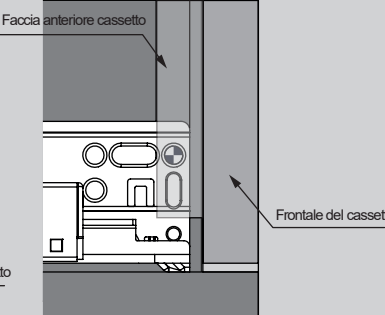

Cassetto standard		X (posizione di foratura)	
Spessore faccia anteriore	13 (1/2")	34 (1-11/32")	37 (1-15/32")
	16 (5/8")	37 (1-15/32")	40 (1-18/32")
	19 (3/4")		

Cassetto rientrante		X (posizione di foratura)		
Spessore faccia anteriore	13 (1/2")	50 (1-31/32")	53 (2-3/32")	56 (2-7/32")
	16 (5/8")	53 (2-3/32")	56 (2-7/32")	59 (2-10/32")
	19 (3/4")	56 (2-7/32")	59 (2-10/32")	62 (2-14/32")
		16 (5/8")	19 (3/4")	22 (7/8")

Spessore frontale cassetto

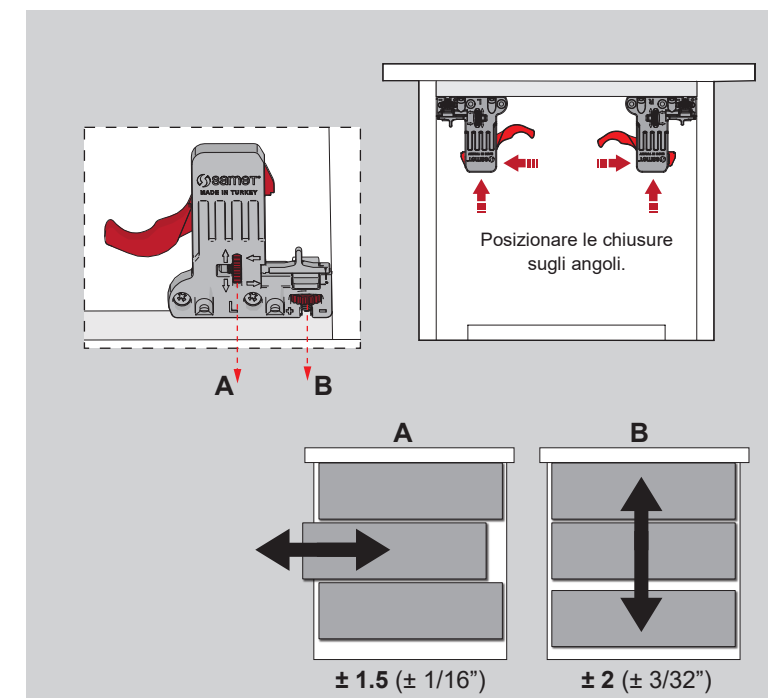
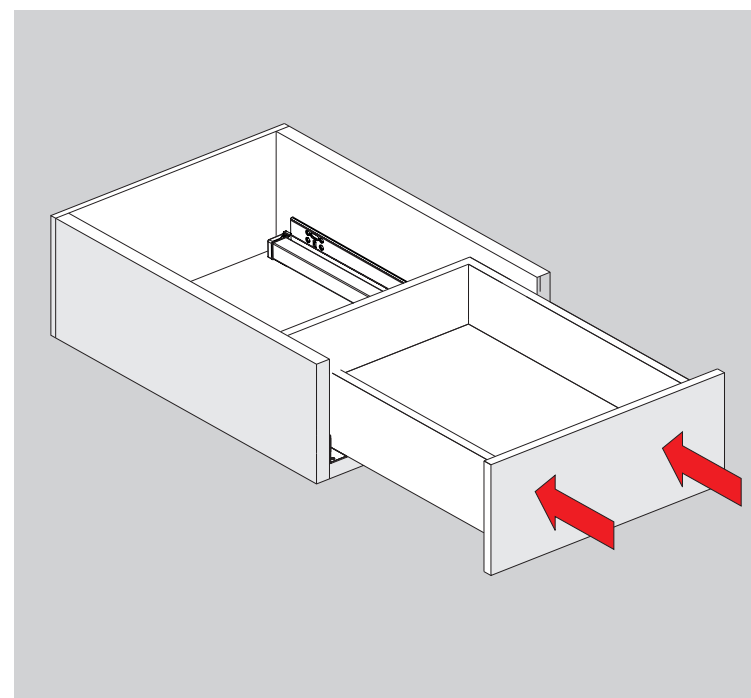
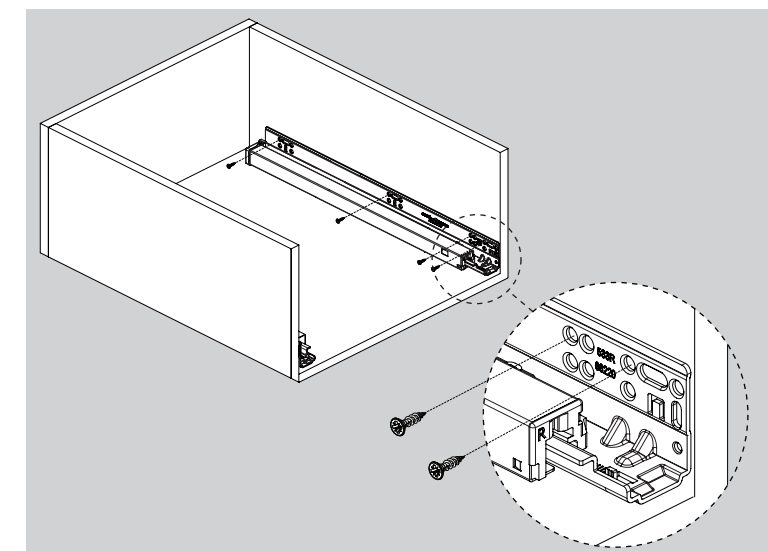
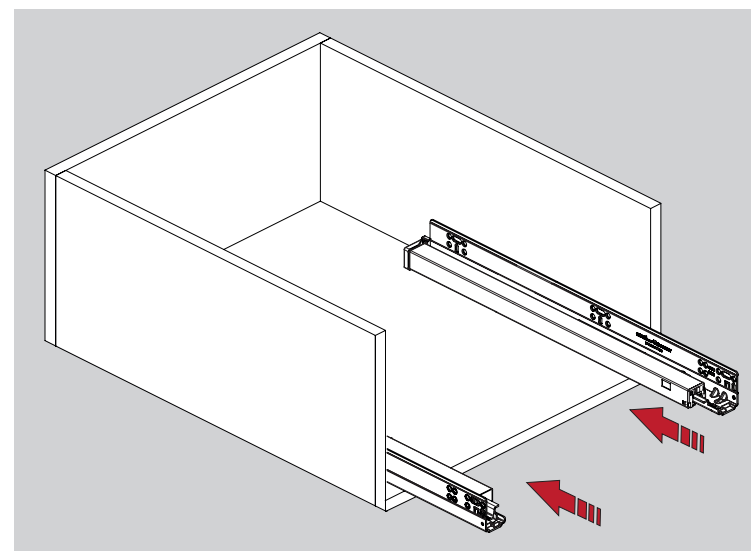

Schema di conversione da millimetri a pollici

1	1.5	2	3	4	5	5.5	6	7	8	9	9.5	10	11	12	13	13.5	14	15	16	17	17.5	18	19	20	20.5	21	22	23	24	24.5	25.4
1/32	1/16	3/32	1/8	5/32	3/16	7/32	1/4	9/32	5/16	11/32	3/8	13/32	7/16	15/32	1/2	17/32	9/16	19/32	5/8	21/32	11/16	23/32	3/4	25/32	13/16	27/32	7/8	29/32	15/16	31/32	1