

Kabin Ölçüleri  
Schrankabmessungen

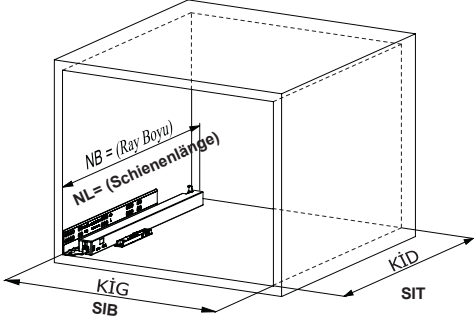

Kabin İç Genişliği	: KİG	Schrank-Innenbreite:	SİB
Kabin İç Derinliği	: KİD	Schrank-Innentiefe:	SİT
Çekmece Derinliği	: ÇD	Schubladentiefe:	SLT
Çekmece İç Genişliği	: ÇİG	Schubladen-Innenbreite:	SLİB
Nominal Boy (Ray boyu):	NB	Nennlänge:	NL

Tavsiye Edilen Vida ve Şablonlar  
Empfohlene Schrauben und Schablonen

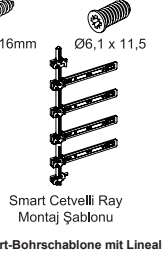
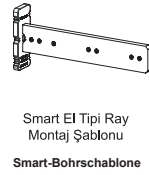
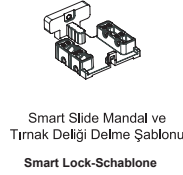

Rayların Vida Konum Ölçüleri  
Schraubenposition der Schienenführungen

Rayı, koyu renk ile işaretlenmiş deliklerden vidalayınız.  
Schauben Sie die Schiene an den markierten Löchern fest.

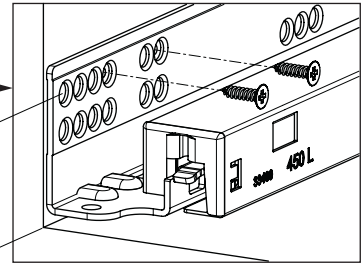
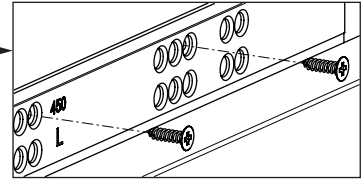
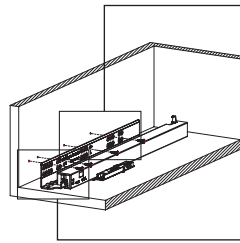
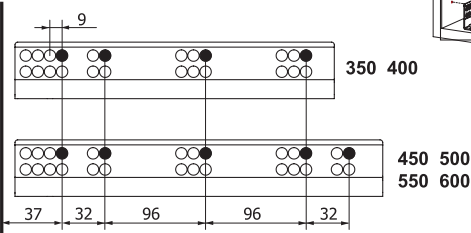

Çekmece Ölçüleri  
Schubladenabmessungen

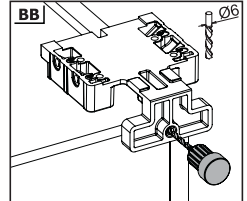
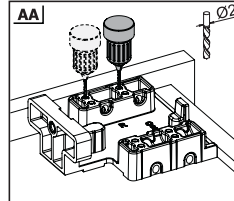
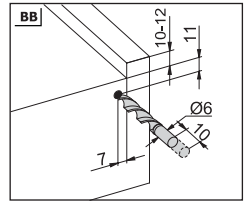
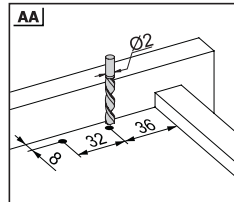
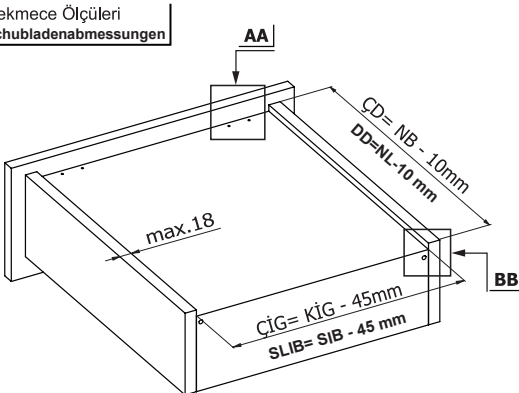

1

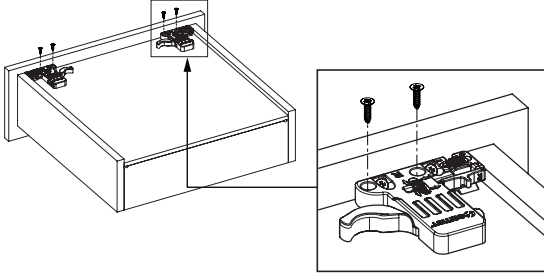

**Not:** Çekmece taban kalınlığı 12 mm'den küçük olduğunda, açılı mandal bağlama deliklerini kullanınız.

**Hinweis:** Verwenden Sie abgewinkelte Löcher, um SmartLock zu montieren, wenn die ausgewählte Holzbodenbreite weniger als 12 mm beträgt.

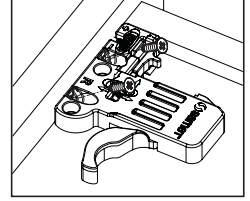
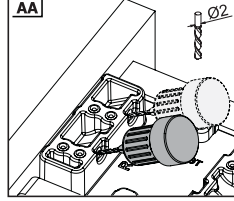

2

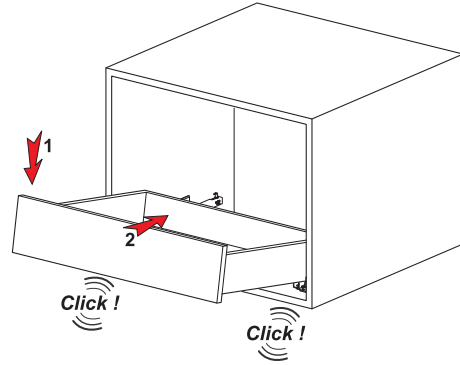

3

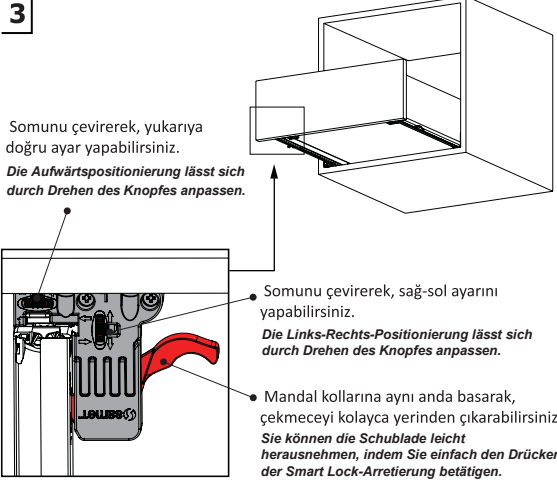

Smart El Tipi Ray  
Montaj Şablonu  
Smart-Bohrschablone

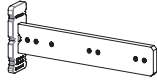

Kod / Code

12799902

12799904

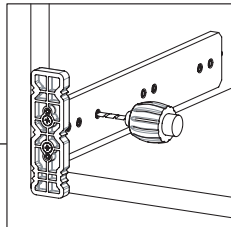
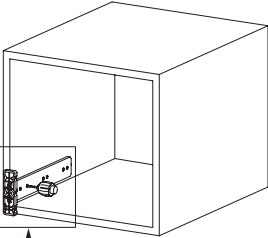

Smart Cetveli Ray  
Montaj Şablonu  
Smart-Bohrschablone mit Lineal

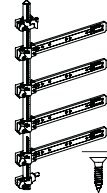

Kod / Code

12799901

12799905

