

Kabin Ölçüleri
Schrankabmessungen

Kabin İç Genişliği	: KİG	Schrank-Innenbreite	: SIB
Kabin İç Derinliği	: KİD	Schrank-Innentiefe	: SİT
Çekmece Derinliği	: ÇD	Schubladientiefe	: SLT
Çekmece İç Genişliği	: ÇİG	Schubladen-Innenbreite	: SLİB
Nominal Boy (Ray boyu): NB		Nennlänge	: NL

Tavsiye Edilen Vida ve Şablonlar
Empfohlene Schrauben und Schablone:Smart Slide Mandal ve
Tırnak Deliği Delme Şablonu
Smart Lock-SchabloneSmart El Tipi Ray
Montaj Şablonu
Smart-BohrschabloneSmart Cetveli Ray
Montaj Şablonu
Smart-Bohrschablone mit LinealRayların Vida Konum Ölçüleri
Schraubenposition der SchienenführungenRayı, koyu renk ile işaretlenmiş deliklerden vidalayınız.
Schrauben Sie die Schiene an den markierten Löchern fest.Çekmece Ölçüleri
Schubladenabmessungen

1

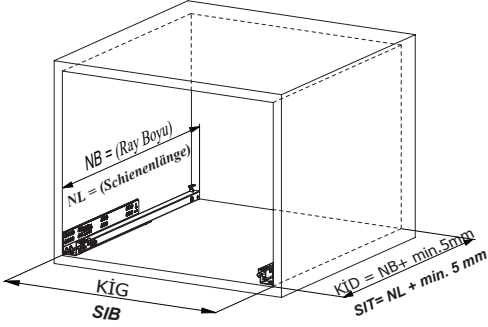
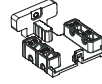
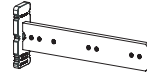
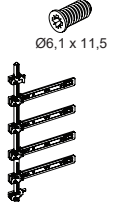
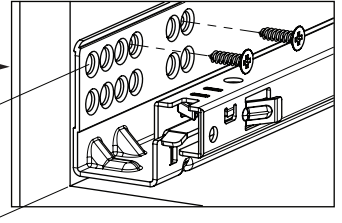
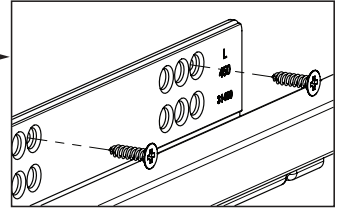
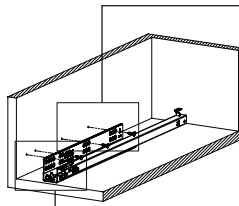
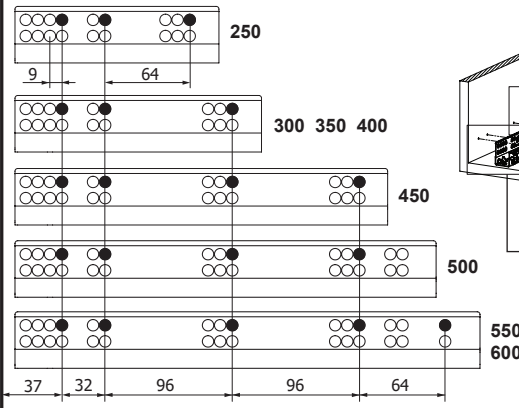
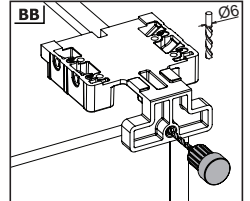
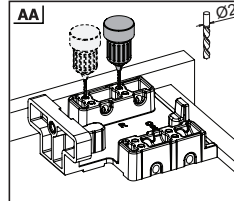
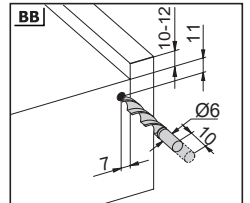
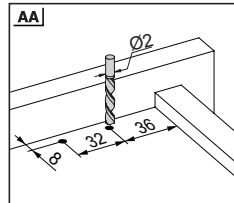
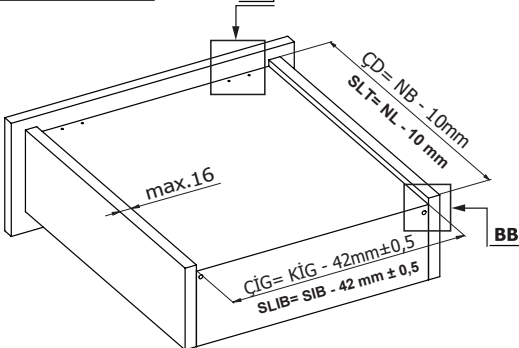
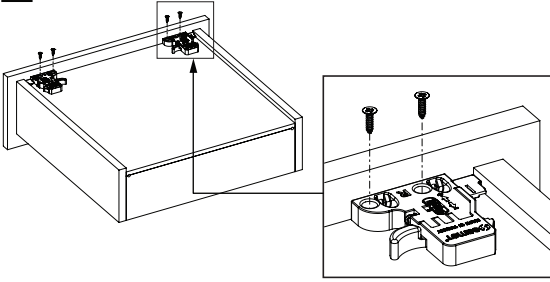

Not: Çekmece taban kalınlığı 12 mm'den küçük olduğunda, açılı mandal bağlama deliklerini kullanınız.

Hinweis: Verwenden Sie abgewinkelte Löcher, um Smart.Lock zu montieren, wenn die ausgewählte Holzbodenbreite weniger als 12 mm beträgt.

AA

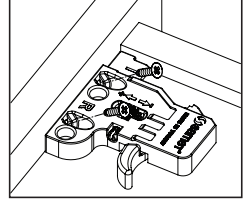
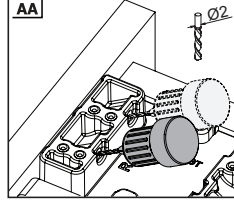

2

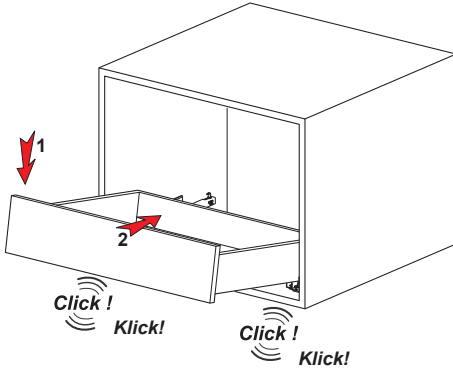

3

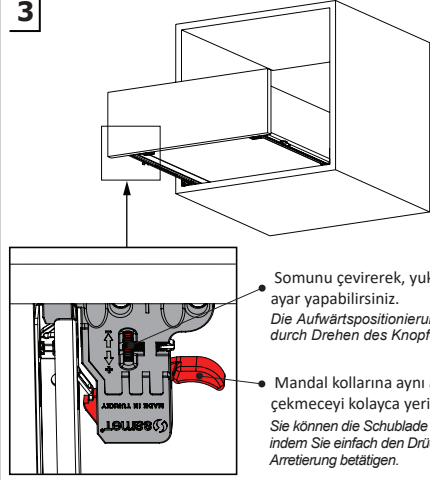

Somunu çevirerek, yukarıya doğru ayar yapabilirsiniz.
Die Aufwärtspositionierung lässt sich durch Drehen des Knopfes anpassen.

Mandal kollarına aynı anda basarak, çekmeceyi kolayca yerinden çıkarabilirsiniz.
Sie können die Schublade leicht herausnehmen, indem Sie einfach den Drücker der Smart Lock-Arretierung betätigen.

Smart El Tipi Ray
Montaj Şablonu
Smart-Bohrschablone

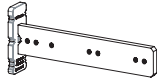

Kod / Code

12799902

12799904

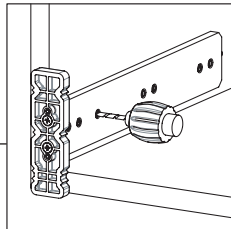
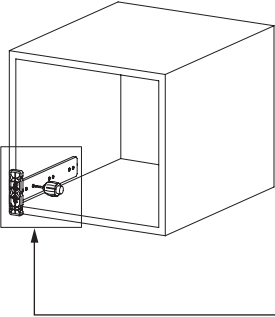

Smart Cetveli Ray
Montaj Şablonu
Smart-Bohrschablone mit Lineal

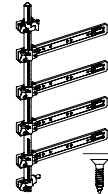

Kod / Code

12799901

12799905

