

# SLIDEASINGLE

Undermount Slide Systems



## A new step towards perfection...

---

Slidea, an inseparable part of elegant and functional life spaces, bring a unique understanding to the concept of drawer in many aspects from elegancy and functionality to practicality and durability.

Slidea is the new name of Slide Systems!

### Slidea Soft - Close

---

Due to the cutting edge technology of new adaptive oil damper, drawers can be closed softly with the same smooth closing effect even if the drawer weight changes. You will enjoy the comfort of smooth closing experience every time.



### Slidea Push - Open

---

Thanks to Slidea Push Open System from now on, your drawers only needs a gentle touch for opening. Widen your freedom of design with non-handle drawers.

You can also make precise alignment on front gap with adjustable push - open version.

Drawer and Cabinet Dimensions S-C [Pin Fix]

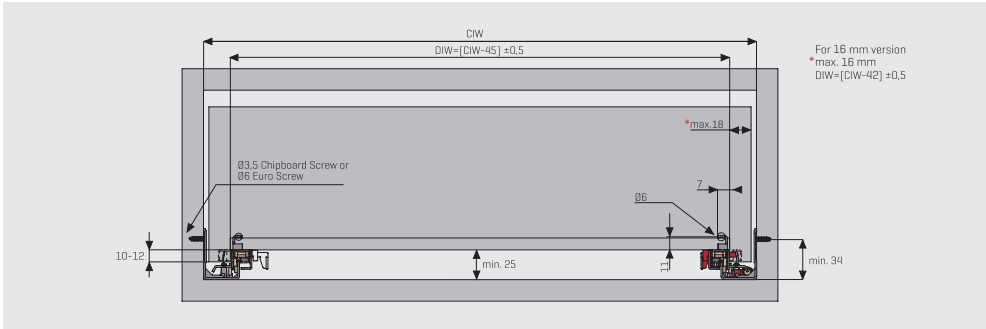

Single Extension Soft-Close Pin Fix [18 mm]

**Boutique Package**  
Right / Left Set

| NOMINAL SIZE | CODE With Brake | PACKING |
|--------------|-----------------|---------|
| 310 mm       | 127227231084    | 12 Set  |
| 335 mm       | 127227233584    | 12 Set  |
| 360 mm       | 127227236084    | 12 Set  |
| 385 mm       | 127227238584    | 12 Set  |
| 410 mm       | 127227241084    | 12 Set  |
| 435 mm       | 127227243584    | 12 Set  |
| 460 mm       | 127227246084    | 12 Set  |
| 485 mm       | 127227248584    | 12 Set  |
| 510 mm       | 127227251084    | 12 Set  |

**Drawer Dimensions**

You should drill the holes before drawer's assembly.

Diagram showing the drawer dimensions and the location of the AA and BB screws. The AA screw is located at the top of the drawer front panel, and the BB screw is located at the bottom of the drawer front panel. The dimensions are: AA (12 mm), BB (10-12 mm), and BB (11 mm).

Diagram showing the nominal size, fitting pin, and safety pin dimensions. The nominal size is NS (mm), the fitting pin is a (mm), and the safety pin is B (mm).

| NOMINAL SIZE NS (mm) | FITTING PIN a (mm) | SAFETY PIN B (mm) |
|----------------------|--------------------|-------------------|
| 310                  | 230                | 210               |
| 335                  | 245                | 225               |
| 360                  | 275                | 255               |
| 385                  | 285                | 265               |
| 410                  | 300                | 280               |
| 435                  | 310                | 290               |
| 460                  | 335                | 315               |
| 485                  | 350                | 330               |
| 510                  | 360                | 340               |

Screw Location for Pin-Fix [18 mm]

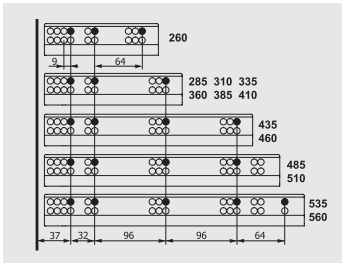

## PIN - FIX ASSEMBLY INSTRUCTIONS

1

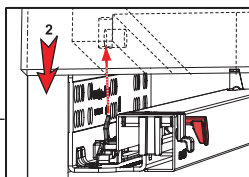
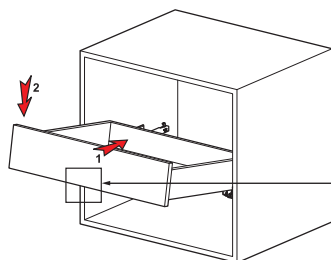

**Important !!!**  
Make sure keep the safety pin open  
before the drawer is placed.

2

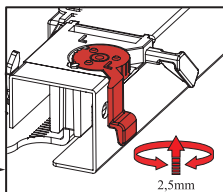
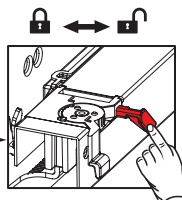
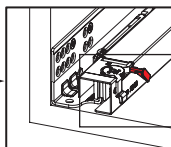
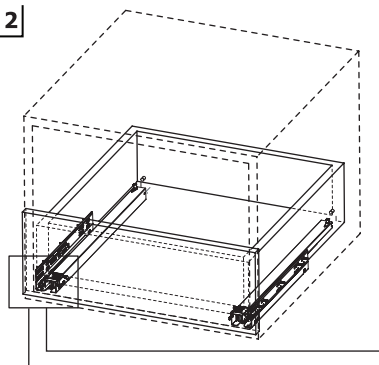

[www.greenplysamet.com](http://www.greenplysamet.com)

