

Kabin Ölçüleri
Dimensions du meuble

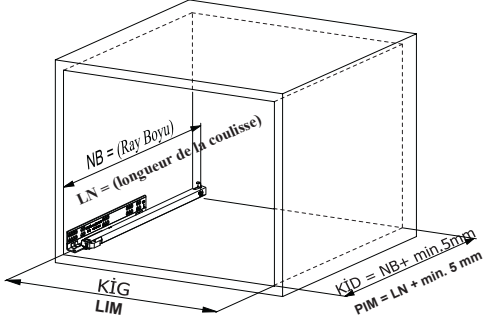

Kabin İç Geniřliđi	: KİG	Largeur intérieure du meuble	: LIM
Kabin İç Derinliđi	: KİD	Profondeur intérieure du meuble	: PİM
Çekmece Derinliđi	: ÇD	Profondeur du tiroir	: PT
Çekmece İç Geniřliđi	: ÇİG	Largeur intérieure du tiroir	: LIT
Nominal Boy (Ray boyu): NB		Longueur nominale	: LN

Tavsiye Edilen Vida ve Şablonlar
Vis et modèles recommandés

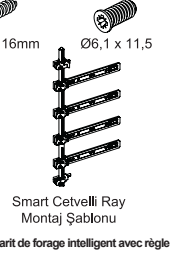
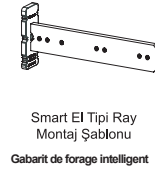
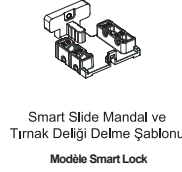
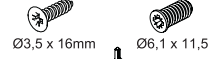

Rayların Vida Konum Ölçüleri
Emplacement des vis des coulisses

Rayı, koyu renk ile işaretlenmiş deliklerden vidalayınız.
Vissez la coulisse dans les trous correspondants.

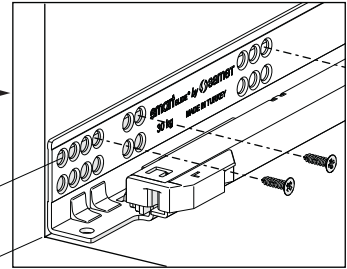
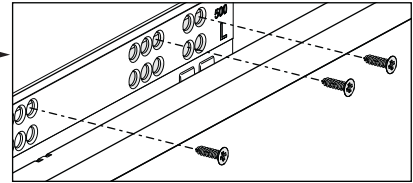
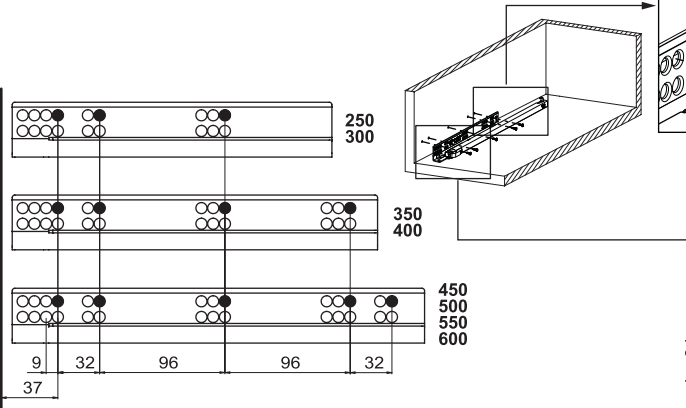

Çekmece Ölçüleri
Dimensions du tiroir

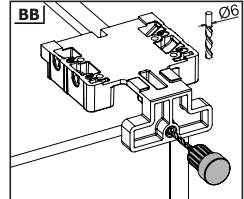
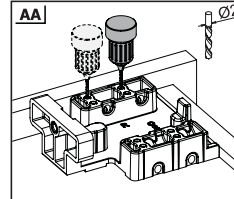
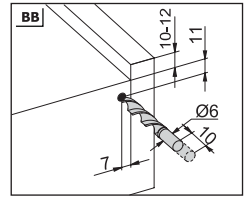
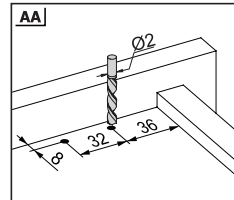
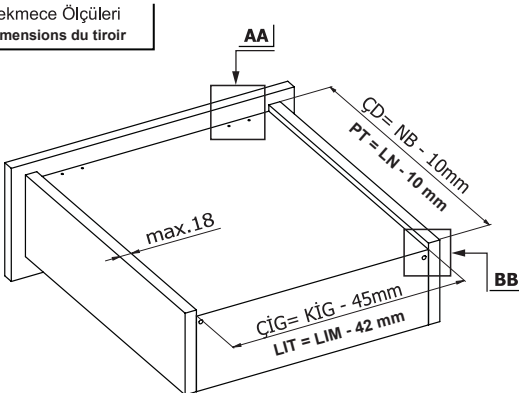

1

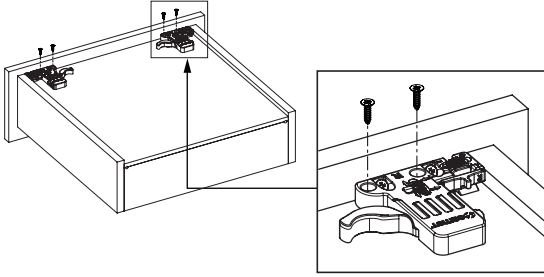

Not: Çekmece taban kalınlığı 12 mm'den küçük olduğunda, açılı mandal bağlama deliklerini kullanınız.

Remarque : Utilisez les trous obliques pour monter la serrure intelligente si la largeur de la planche de bois est inférieure à 12 mm.

AA

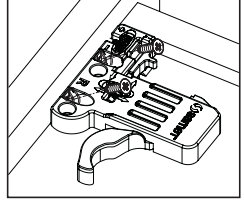
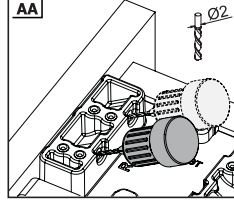

2

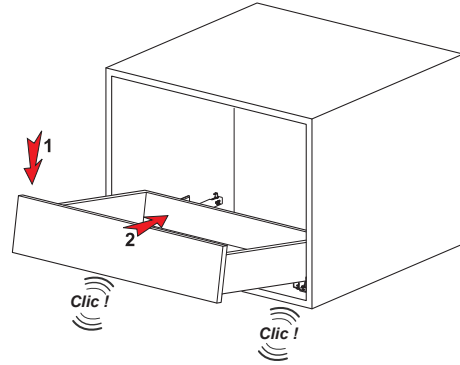

3

Somunu çevirerek, yukarıya doğru ayar yapabilirsiniz.

Vous pouvez régler le positionnement vertical en tournant le bouton.

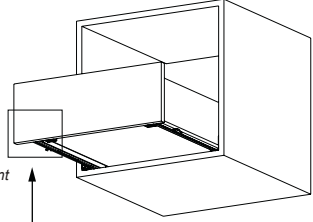
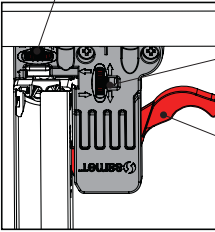

Somunu çevirerek, sağ-sol ayarını yapabilirsiniz.

Vous pouvez régler le positionnement gauche-droite en tournant le bouton.

Mandal kollarına aynı anda basarak, çekmeceyi kolayca yerinden çıkarabilirsiniz.

Vous pouvez facilement sortir le tiroir en appuyant simplement sur le loquet smart lock

Smart El Tipi Ray
Montaj Şablonu
Gabarit de forage intelligent

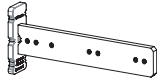

Kod / Code

12799902

12799904

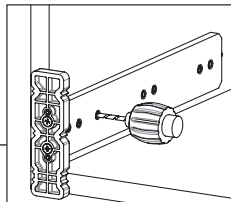
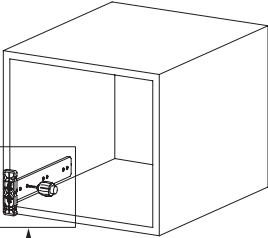

Smart Cetveli Ray
Montaj Şablonu
Gabarit de forage intelligent avec règle

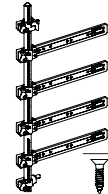

Kod / Code

12799901

12799905

